

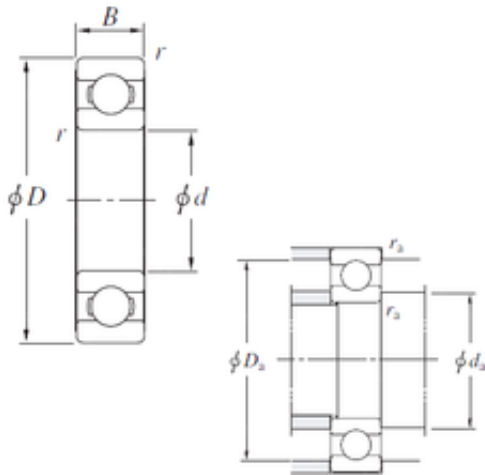

PRECISION BEARING ACCESSORIES SPAIN C...



6088 Bearing 2D drawings and 3D CAD models

6088 KOYO Single-row deep groove ball bearings

Bearing No. 6088

Size	440x650x94 mm
Bore Diameter	440 mm
Outer Diameter	650 mm
Width	94 mm
d	440 mm
D	650 mm
B	94 mm
r min.	6 mm
da min.	464 mm
Da max.	626 mm
ra max.	5 mm
Weight	105 Kg
Basic dynamic load rating (C)	526 kN
Basic static load rating (C0)	902 kN